

LIFTER RINGS

TF-101 LR

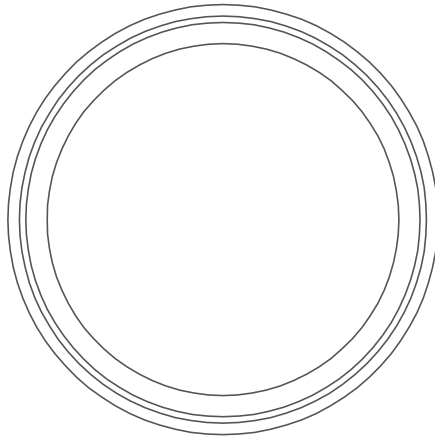

PLAN

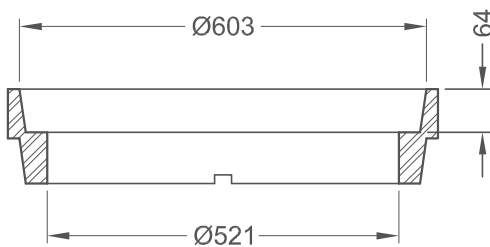
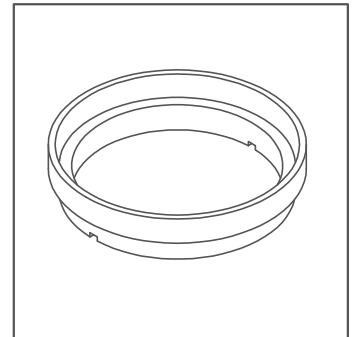

SECTION

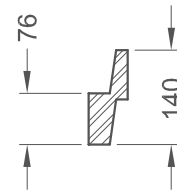

76MM RING

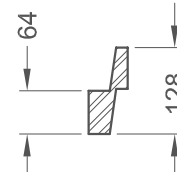

64MM RING

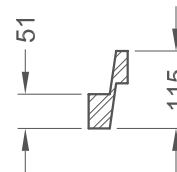

51MM RING

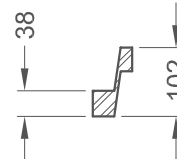

38MM RING

ISO 9001-2000 CERTIFIED

RATED FOR HS-20 LIVE LOAD

MEASUREMENTS IN MILLIMETERS



1350 FIFE STREET
WINNIPEG, MB
R2X 2N7
(P) 204.633.5535
(F) 204.694.2210